



# 2-Way Stripline Power Divider

## MODEL D-560-2T

### OUTLINE DRAWING

UNIT: INCH

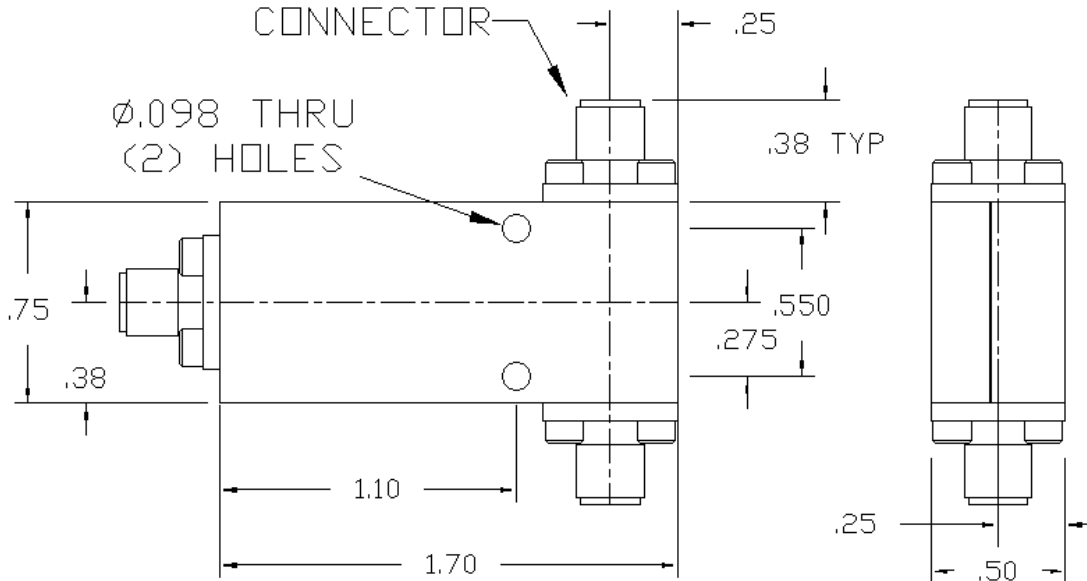

ELECTRICAL SPECIFICATIONS	FREQUENCY RANGE		5.0-60.0	GHz
		INPUT VSWR	Max.	1.80:1
	OUTPUT VSWR	Max.	1.80:1	
	AMPLITUDE BALANCE	Max.	1.0	dB
	PHASE BALANCE	Max.	8.0	Deg.
	INSERTION LOSS	Max.	4.0	dB
	ISOLATION	Min.	5-10:15.0	dB
			10-60:20.0	
	POWER RATING	Avg.	10.0	W
		Peak	1.0	kW
PHYSICAL SPECIFICATIONS	CONNECTOR TYPE		1.85mm (V) Female	
	WEIGHT	Max.	1.30	Oz
	OPERATIONAL TEMP.		- 32 to + 85 °C	

