



2-Way Stripline Power Divider

REV.2010.A

MODEL D-640-2

OUTLINE DRAWING

UNIT: INCH

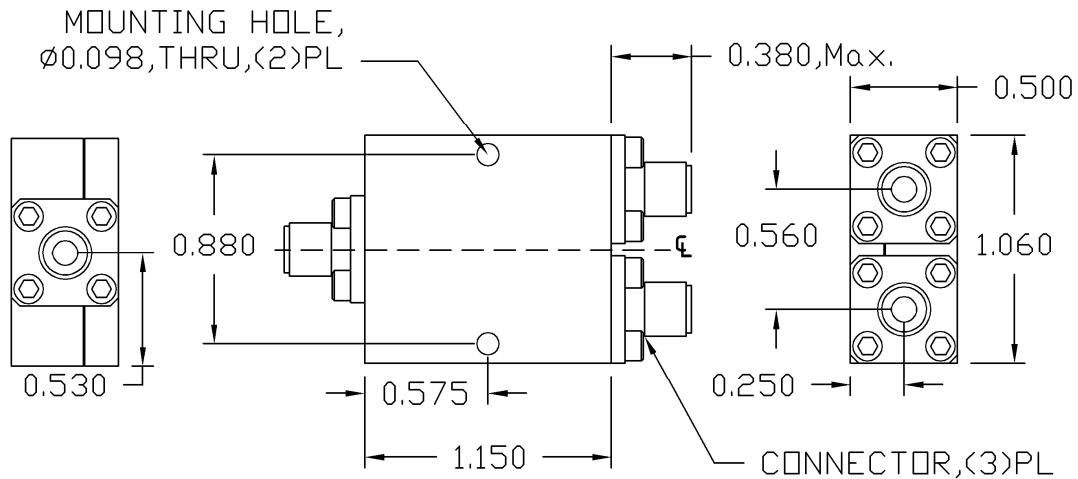

ELECTRICAL SPECIFICATIONS	FREQUENCY RANGE		6.0-40.0	GHz
		INPUT VSWR	Max.	1.50:1
	OUTPUT VSWR	Max.	1.50:1	
	AMPLITUDE BALANCE	Max.	0.40	dB
	PHASE BALANCE	Max.	4.0	Deg.
	INSERTION LOSS	Max.	1.50	dB
	ISOLATION	Min.	18.0	dB
POWER RATING		Avg.	20.0	W (See Note 1)
		Peak	3.0	kW
PHYSICAL SPECIFICATIONS	CONNECTOR TYPE		2.92mm (K) Female	
	WEIGHT	Max.	1.38	Oz
	OPERATIONAL TEMP.		- 32 ~ + 85	°C
	STORAGE TEMP.		- 40 ~ + 85	°C

***Note1:**

Rating power at the ports is 20 Watts at VSWR=1.50:1
And 2 Watts at VSWR = Infinite

